



Chacewater Crescent, Worcester, WR3 7AN

Offers Over £350,000

3 1 1



A fantastic opportunity to purchase a three bedroom detached bungalow in the sought after area of Northwick. The bungalow is in need of modernisation which makes this perfect for putting your own stamp on. It has a great South facing garden which offers good privacy. The bungalow benefits the entrance hall, kitchen, lounge, three bedrooms, and family bathroom. Gas central heating, double glazing, garage, front and rear gardens. The property is being offered with no onward chain. Viewing is recommended to appreciate the potential and location. Lovely walks on the doorstep and lots of local ammenities close by.





Chacewater Crescent, Worcester

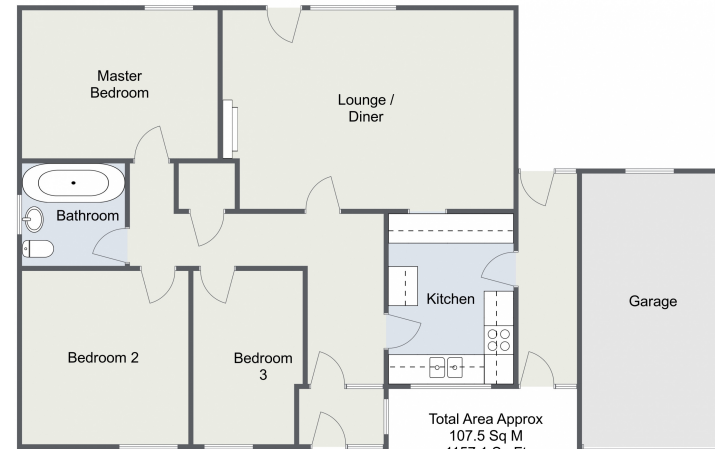

For illustrative purposes only. Decorative finishes, fixtures & fittings do not represent the current state of the property. Measurements are approximate & not to scale. Floor Plans made using RoomSketcher.



Energy Efficiency Rating

	Current	Potential
Very energy efficient - lower running costs		
(92 plus) A		
(81-91) B		85
(69-80) C		
(55-68) D	68	
(39-54) E		
(21-38) F		
(1-20) G		
Not energy efficient - higher running costs		
England & Wales	EU Directive 2002/91/EC	

For more information on this house or to arrange a viewing please call the office on:

01905 958 290

Alternatively, you can scan the QR to view all of the details of this property online.



arden
ESTATE AGENTS